



***New- 2010 IT30S
30' Renegade Stacker Trailer
T-1708 In Stock \$48,635***



30' Long
138" Interior Height & 100" Interior Width
76" Headroom Under Attic
Axles: (3) 7,000# Spring Axles w/ Electric Brakes
Load Range "G" 16" Tires w/ Aluminum Wheels
Construction: Hard Body FRP (Fiberglass Reinforced Panel)
5/8" FRP Walls- Smooth Seamless Finish
5/8" FRP Roof- 100% Walk-On Roof
6" I-Beam Frame w/ 16" OC Cross Members
96" Attic/ 2"x2" Steel Tubing w/ FRP Floor
Aluminum Plank Flooring (upgraded to rubber)
Electric/Hydraulic Tongue Jack
24" Stainless Trim on Lower Exterior
7' Rear Door Ramp w/ Spring Assist w/ 3' Ramp Extensions
4' Beavertail
16' Hydraulic Car Lift w/ Solid Floor & Remote
54" Entrance Door w/ Step Well
(8) D- Rings
Spare Tire & Aluminum Wheel
Roof & Attic Access Ladder on Road Side (moved to curb side)
Electrical:
30 Amp Breaker Box & 55 Amp Converter
(2) 100 Amp Deep Cycle Batteries
30 Amp Marine Style Shore Cord (25')
(8) Double 48" Fluorescent Lights
(2) Single 18" Fluorescent Lights
(2) 110v Receptacles
(9) 12v Lights
(4) Light Switches
All Wiring is Bright Aluminum Covered or in Flat Conduit
LED Tail & Marker Lights
(2) Exterior Quartz Lights
(1) Exterior Receptacle
Cabinets:
Aluminum Cabinet Fronts w/ FRP Sides
76" x 24" Closet w/ Shelf & Hanger
6' of Base Cabinet
6' of Overhead Cabinet
Doors w/ Positive Latches
Options:
AM/FM/CD Stereo w/ Exterior Speakers
Rear Quartz Lights
Escape Hatch & Ladder to Roof
Back-Up Camera Installed
Black Rubber Flooring
Ladder Moved to Curb Side- (Room for Tool Box)
Air Compressor Prep w/ 3 Air Lines



Westside Motorcoach
11201 S. Grant Hwy Rt. 20
Marengo, IL 60152
Contact: Bob (847) 812-2972
Fax (815) 923-0101



Renegade Motorhomes & Trailers

52216 SR 15, Bristol, Indiana 46507 USA
 Tel 574.848.1126 www.kibbi.com Fax 574.848.1127

Trailer Sales Order

KIBBI#	T1708	FOR	Westside Motorcoach
Order Date:	Model IT30S		11201 S. Grant Hwy
REP TW	G.V.W.R.		Marengo, IL 60152
Customer:		Phone:	(847) 812-2972
		Fax:	(815) 923-0101
VIN	1K9500P3791160137		

Options

2009 Base	102"Wx138"IntHtx30'L	X
Additional Height		X
Axle	(3) 7000#	X
Brakes	Electric	X
Suspension	Spring	X
Tire Size	LT235/85R 16	X
Wheels	HWT	X
Spare Tire		X
Coupler	2 5/16"	X
Hitch	Tag	X
Frame	6" I-Beam	X
Beavertail	4'	X
Jack(s)	(1) Elec/Hyd Tongue	X
Flooring	Rolled Rubber Coin	X
Exterior Color	White	X
Attic	9'	X
Rear Door	7' Ramp w/ Spring Assist	X
Side Door	54" Double	X
Interior Lift	16' Hyd.	X
Stainless Trim	30'	X
Electric Package	30 Amp	X
Power Convertor		X
Quartz Lights	(2) CS Bal (2) Rear	X
Air Compressor	Prep Only	X
Air Lines	(3)	X
AM/FM/CD Stereo		X

1	Aluminum Cabinet Fronts w/ FRP Sides-IT30S Pkg.
2	(2)76"x24" Closet w/shelf&hanger 6' Base Cabinets 6' Overhead cabinets
3	(8) D-Rings
4	Attic Access ladder R/S
5	(2)Strap Hangers
6	Rubber Mat on Countertops
7	48" Single Aluminum Step
8	Removable Solid Floor for Lift
9	Escape Hatch
10	Pair Ext Speakers
11	(1) Air Chucks C/S Rear (1) C/S Behind Side Dr (1) R/S Above Cabinet Front Wall Like T1646 (1) Note: Rolled rubber coin flooring to be on ramp door also (1) Use Back-up Camera from K2358 (1) Move attic access ladder to C/S like T1646
MSRP: \$61,089	
Normal Price: \$50,183	
Discounted Price: \$48,635	
	Subtotal
	Paint
	Options
	Total
	\$48,635.00

T-1708

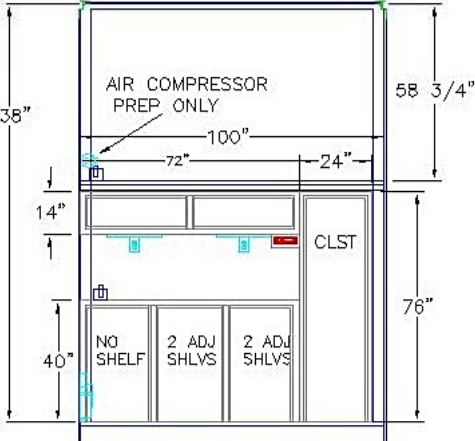
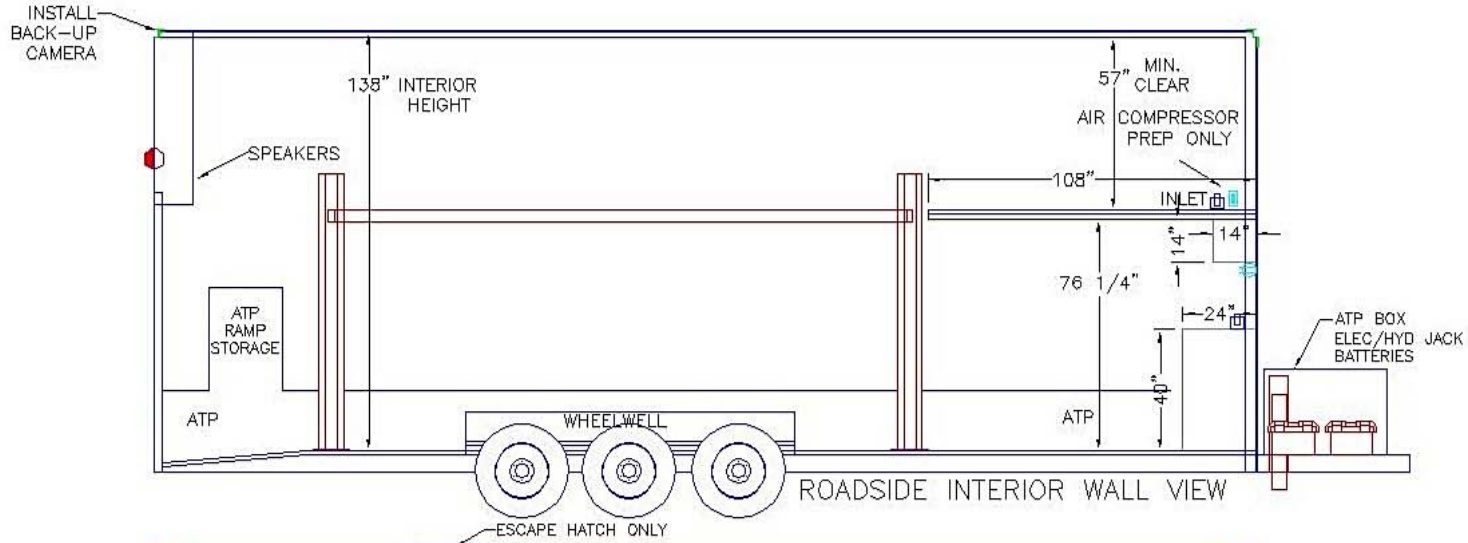

FRONT WALL VIEW

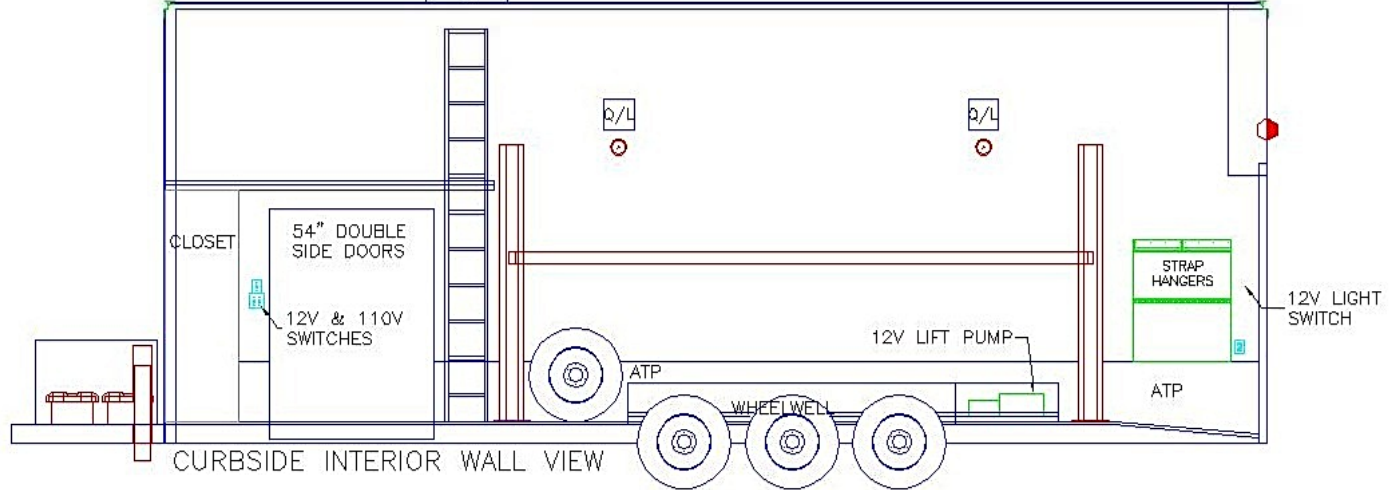





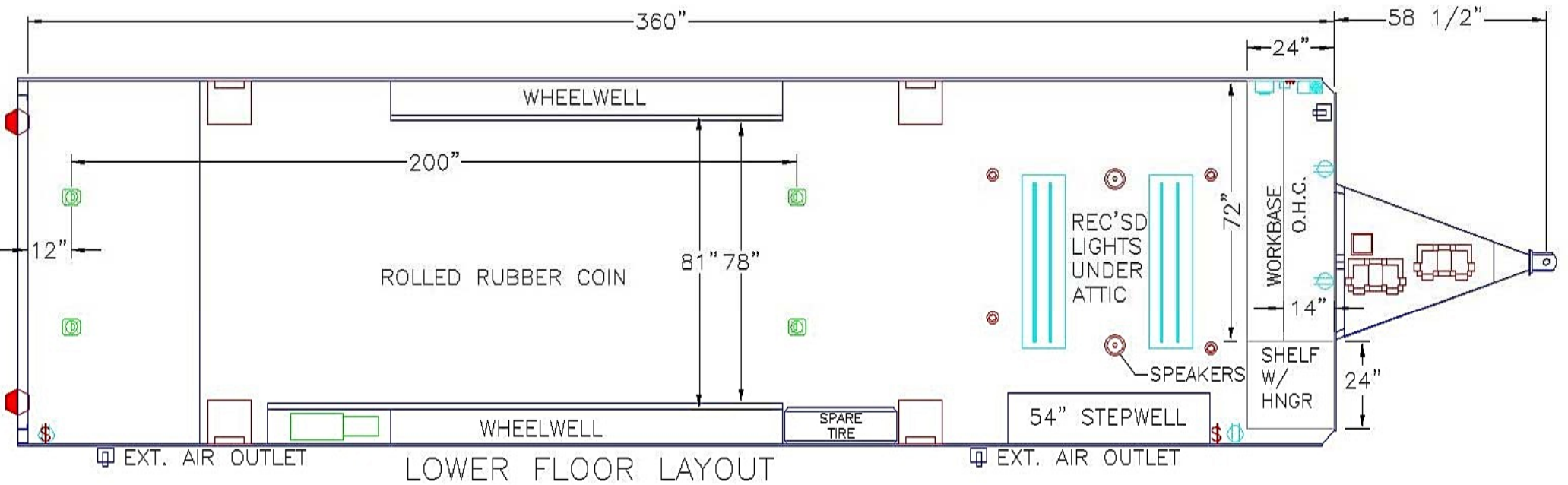
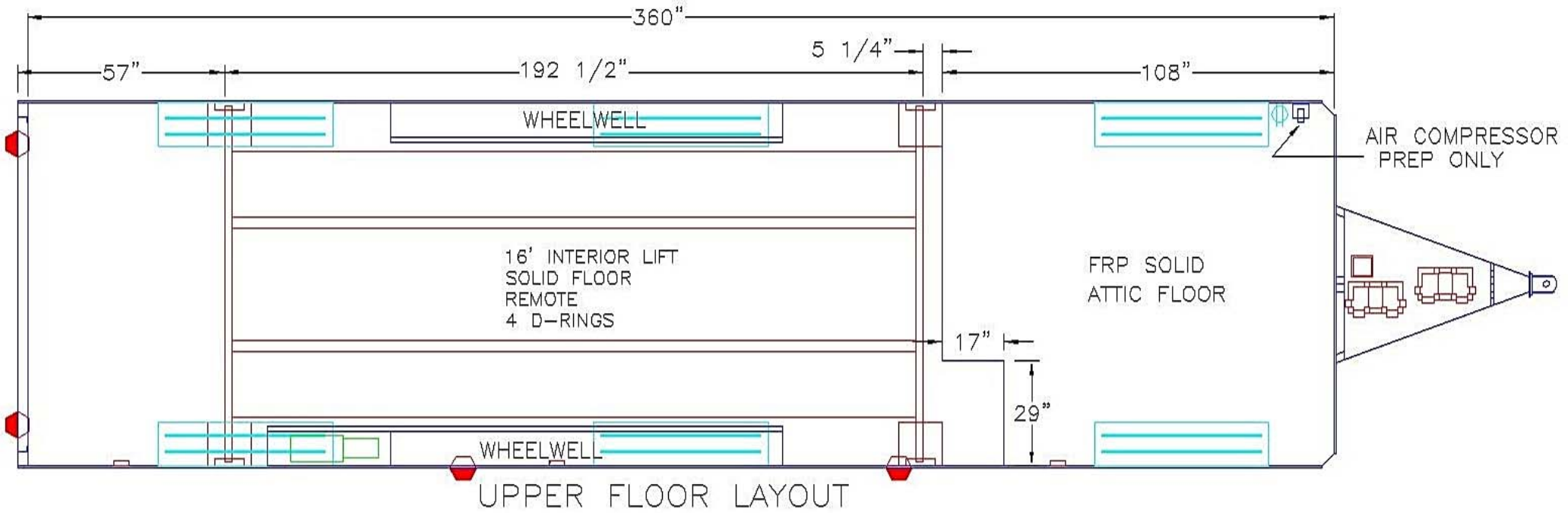

CURBSIDE INTERIOR WALL VIEW

T-1708



JOB#:	T-1708
AXLES:	3-7,000# DEXTER
SUSPENSION:	SPRING
BRAKES:	ELECTRIC
COUPLER:	2 5/16" 25,000# TAG
HITCH:	A-FRAME
WHEELS:	16" HWT ALUMINUM
TIRES:	LT235/85R 16
REAR DOOR:	7' RAMP W/ SPRING ASSIST
ELECTRIC PACKAGE:	30 AMP SUPPLY
STAINLESS:	EXTERIOR SIDES AND RUBRAILS
OPTIONS:	
MATCHING TRUCK K2358	
ROLLED RUBBER COIN FLR. & RAMP DR.	
(2) EXT SPEAKERS	
AM/FM/CD STEREO	
ESCAPE HATCH	
INSTALL BACK-UP CAMERA K2358	
AIR COMPRESSOR PREP	
(3)-AIRLINES	
48" ALUMINUM WELDED STEP	

 = LIGHT SWITCH
 = RECEPTACLE
 = 500W QUARTZ LIGHT
 = 18in. FLOURESCENT LIGHT
 = 48in. FLOURESCENT LIGHT
 = 12V LIGHT
 = AIR OUTLET



JOB NO. T-1708	DATE: 09/28/09	REVISED:
DRAWING NAME: T-1708-IT30S-54-6INMF		
CUSTOMER: WESTSIDE MOTORCOACH		
DRAWN BY: C. Minier	SCALE: NONE	



Renegade



Motorhomes
Garage Units
Toterhomes
Stacker-
Trailers

Nationwide
Sales
&
Delivery

Truck Service
& Parts

Financing



Renegade

Renegade Custom Coaches & Trailers



11201 S. Grant Hwy
Marengo, IL 60152

Call: Bob (847)812-2972

www.westsidemotorcoach.com